



EXTERNAL RADIOCOMMAND-RECEIVERS

FA01700-EN



CE

EAC



INSTALLATION MANUAL

RBE4230 - RBE4024

EN English

IMPORTANT SAFETY INSTRUCTIONS WHEN INSTALLING
WARNING: INCORRECT INSTALLATION MAY RESULT IN SERIOUS HARM, FOLLOW THE INSTALLATION INSTRUCTIONS.
THIS MANUAL IS EXCLUSIVELY INTENDED FOR PROFESSIONAL, SKILLED STAFF

KEY

-  This symbol shows which parts to read carefully.
-  This symbol shows which parts describe safety issues
-  This symbol shows which parts to tell users about.

The measurements, unless otherwise stated, are in millimeters.

DESCRIPTION

External four-channel receiver, for radio controlling operators and accessories. Multi-frequency (see table), stores up to 3,000 user/codes. It also manages the S5000/6000/7000 digital keypads and the TSP00 and LT001 sensor transponders.

It features a four-digit display and a Memory Roll card for storing and saving data.

You can remotely program and control the system: via the CRP, or, from a PC USB port, or by downloading free RBE-software from www.came.com.

Transmitter compatibility table:

Frequency	AF card	Series	Transmitters
433.92 MHz	AF43S	ATOMO	All models
		TAM	All models
		TOP	All models
		TWIN	only TW2EE - TW4EE
		S9000 radio keypad	
868.35 MHz	AF868	ATOMO	All models
		ATP	ATP864
		TOP	All models

Dimensions

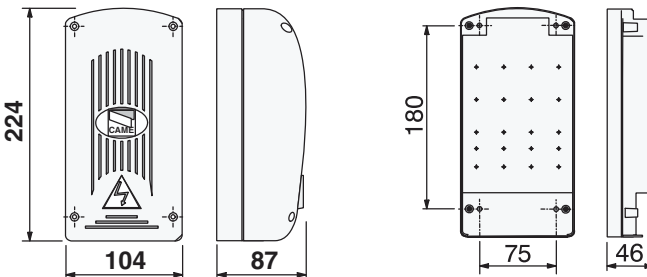

Technical data

Type	RBE4024	RBE4230
Protection rating (IP)	54	54
Power supply (V)	24 AC/DC	120 - 230 AC
Frequency (Hz)	/	50/60
Stand-by consumption (W)	0.43	0.67 - 0.8
Maximum power (W)	4.4	3 - 3.2
Relay contact rating - resistive load $\cos\phi=1$ (A/V)	5 / 230	5 / 230
Relay contact rating - (A/V) inductive load	1.5 / 230	1.5 / 230
Casing material	ABS	ABS
Operating temperature (°C)	-20 ÷ +55	-20 ÷ +55
Storage temperature (°C)*	-25 ÷ +70	
Average life (hours)**	100,000	
Apparatus class	III	II
Weight (Kg)	0.55	0.6

(*) Before installing the product, keep it at room temperature where it has previously been stored or transported at a very high or very low temperature.

(**) The average product life is a purely indicative estimate. It applies to compliant usage, installation and maintenance conditions. It is also influenced by other factors, such as climatic and environmental conditions.

Fuses	RBE4024	RBE4230
LINE FUSE - Line (mA)	315 T	315 T

INSTALLING

Fitting

Place the casing where it is protected, and at least five meters from any other receivers; and place the antenna as high and as far as possible from any metal or reinforced concrete structures.

Use $\varnothing 6$ cylinder head screws and suitable cable glands to ensure the IP is held fast.

Fit suitable cable glands, by drilling the marked inputs under the control panel.

⚠ Be careful not to damage the control board.

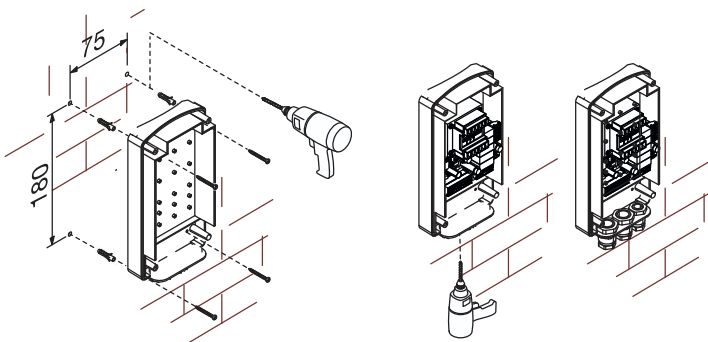

Board description

1. Power-on LED
2. Programming display
3. Programming Buttons
4. SIPA06 CLOCK control-card connector
5. RSE card connector
6. AF/R700/R800 card connector
7. CRP connection terminals
8. Antenna connection terminals
9. keypad/transponder connector terminals
10. USB connection LED
11. Mini USB connector
12. Terminals for connecting devices to govern
13. Control board power-supply terminals
14. Fuse case
15. Transformer (only RBE4230)
16. Memory Roll card connector

